

AIR-MOTION 12 QUICK SPECIFICATIONS

- Overview:**
- Operator has total, full-variation control of convection and conduction heat transfer via a patented "Open Chamber Roasting" fluid-bed 12 kg air-roasting chamber.
 - All electric. No fuel or afterburner needed.
 - Extremely low emissions. Environmentally smart.
 - Clean, consistent roast every time.

CAPACITY/OUTPUT

- Batch Size:** Max 12 kg roasting capacity (26 lbs of green beans)
- Roast Time:** 8-12 minutes (dependent on roast level)
- Output:** Max 100 lbs/hour; 800 lbs/day (based on 8-hour day)

DATA LOGGING

- Internal:** 5 real-time graphs: bean temp, heater temp, RoR bean temp, RoR heater temp, and saved profile curve line

CONTROL POINTS

- Integrated touchscreen control panel
- Presetting profile parameters
- Fast-reacting thermocouples
- Quick-response heat transfer
- Speed controller to adjust bean lifting height during roasting

ELECTRICAL REQUIREMENTS

- 3-Phase:** 480 V // 60 Hz // 42 Amps

COMPONENTS

- Air Flow:** High-efficiency 4 kW heater blower
- Cooling:** Optional 30-40 second water dousing system for high-speed bean cooling
- Extraction:** Centrifugal 2.6 kW extraction fan immediately moves dust, smoke, and chaff from roast chamber
- Heating:** 27 kW Nichrome plated electrical spiral elements
- Roast Chamber:** Stainless steel construction, durable, easy cleaning

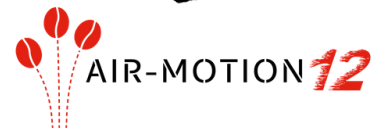

Take advantage of
our private,
competitive
lending program,
AMR Approved!

Visit
www.air-motionroastersusa.com/financing/

Info:
855.579.6400

sales@
air-motion
roastersusa.com



DIMENSIONS AND WEIGHT: AIR-MOTION 12 ROASTER COMPONENTS

To allow for best space planning, measurements account for the widest, tallest, and deepest parts of components (e.g., touchscreen arm, casters, etc.).

COMPONENT	RAW UNCRATED WEIGHT	DIMENSIONS (L x W x H)
Roast Chamber	275.6 LBS (125 KG)	32.3" L x 35.5" W x 53.2" H (2.7' L x 2.9' W x 4.4' H)
Cyclone	275.6 LBS (125 KG)	56.1" L x 31.5" W x 85.4" H (4.7' L x 2.6' W x 7.1' H)
Cooling Tray	101.4 LBS (46 KG)	35.9" L x 33.1" W x 15.7" H (2.9' L x 2.8' W x 1.3' H)
TOTAL	652.6 LBS (296 KG)	

DIMENSIONS AND WEIGHT: AIR-MOTION 12 ROASTER CRATING

CRATE	CRATED WEIGHT	CRATE DIMENSIONS (L x W x H)
Crate #1	See note below.	89" L x 59" W x 43" H (7.4' L x 4.9' W x 3.6' H)
Crate #2	See note below.	43" L x 33" W x 56" H (3.6' L x 2.75' W x 4.7' H)
TOTAL	1,091 LBS (495 KG)	

NOTE: Weight provided is total weight for both crates. Individual crate weights will be received prior to shipping.

DIMENSIONS: AIR-MOTION 12 FOOTPRINT

FOOTPRINT: 73.4" L x 68" W x 85.4" H

CLEARANCE: 31.5" L x 31.5" W x 20" H

ROASTER HEIGHT: 85.4"

MINIMUM CEILING HEIGHT: 91"

AIR-MOTION 12 CYCLONE VENTING DIAMETER

Exit Pipe Diameter: 247 mm

Outside Diameter of aluminum flex pipe: 250 mm (3mm wall thickness)

Purchase ducting from **Nordfab** or **Selkirk**.

AIR-MOTION 12 WATER SPECIFICATIONS

Intake Connection: 1/4" NPT pipe

Pressure: 60 psi

MAINTENANCE

The only maintenance required is the emptying of the Chaff Collector Bucket every couple of days depending on the frequency of roasting and the wiping down of the Roast Chamber with a wet cloth after completion of roasting schedule for the day.

REPLACEMENT PARTS (IF NEEDED)

The only parts that may need to be replaced due to natural wear and tear:

- Blower fan
- Element bank

Contact Air-Motion Roasters USA to purchase replacement parts.

DECIBEL READING

85 dB

CERTIFICATIONS

CE approved and built to UL standards, IEC (International Electrotechnical Commission)

SERVICING

No servicing is required other than the Maintenance Schedule as listed.

WARRANTY

AMR provides a 2-year warranty on all machine parts.

EMISSION TESTING

Emission testing report included in User Manual.

REQUIRED CLEARANCES

Position roaster at least 24" from walls or other equipment, and allow for at least 48" in front of roaster for user operation.

AIR-MOTION 12 ROASTER LAYOUT

See next 4 pages for 12kg AMR roast chamber, cooler tray, and cyclone footprint, weight, layout, and dimensions.

AIR-MOTION 12: FOOTPRINT

COMBINED WEIGHT:
652.6 lbs

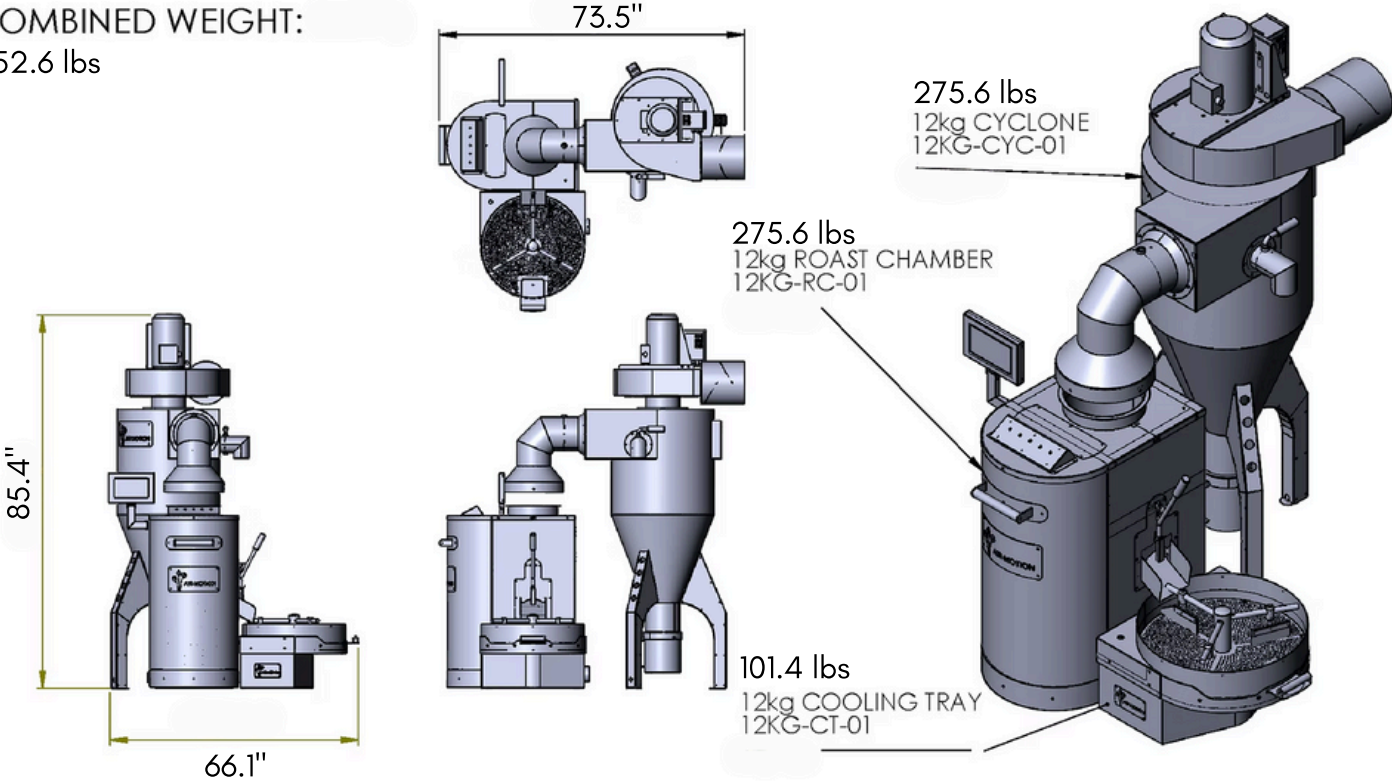

AIR-MOTION 12: ROAST CHAMBER

WEIGHT: 175.6 lbs (125 kg)

Below measurements are provided in inches, feet, and millimeters (mm).

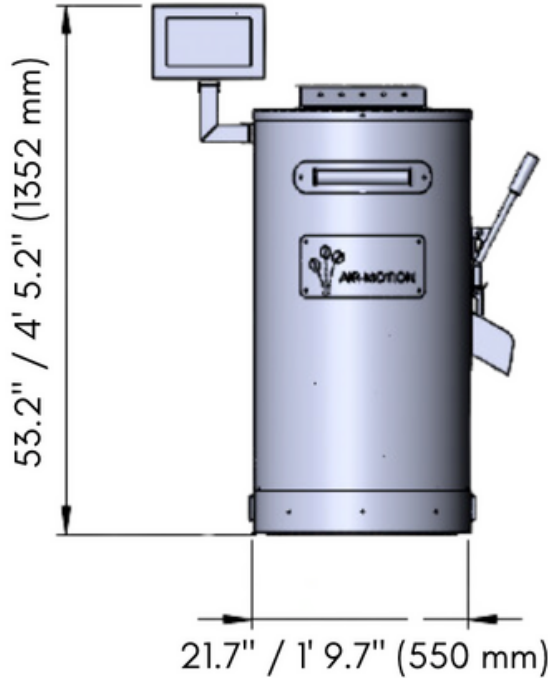

FRONT VIEW

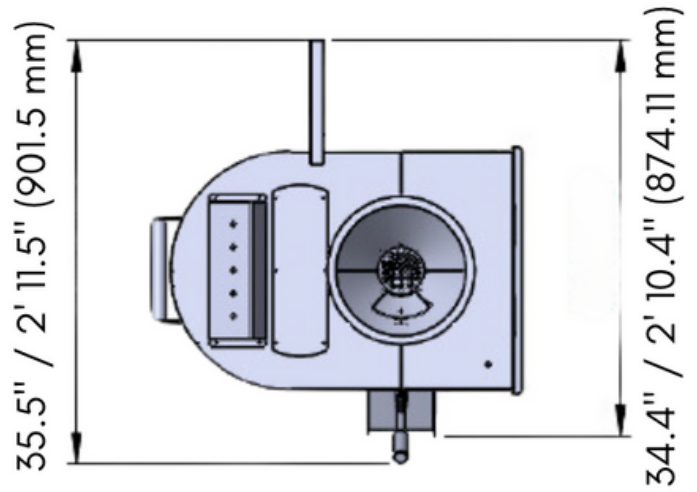

TOP VIEW

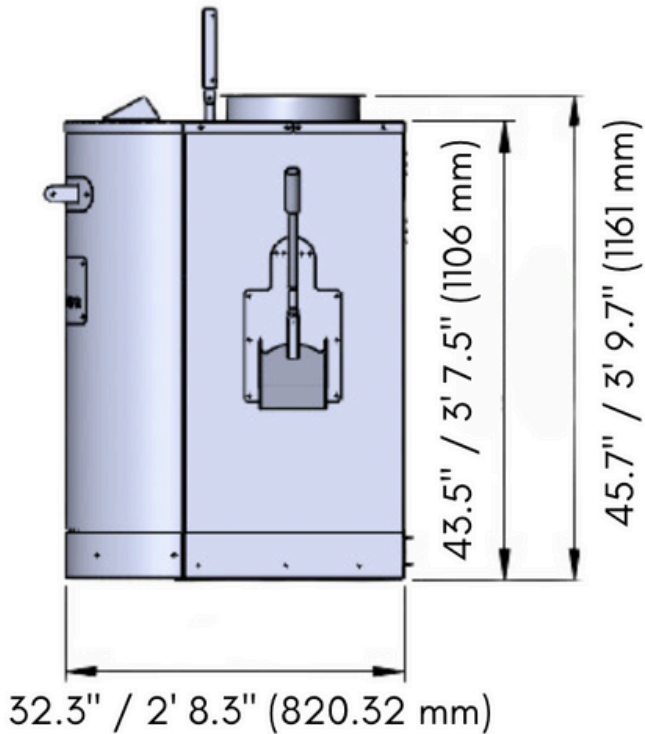

SIDE VIEW



AIR-MOTION 12: COOLER TRAY

WEIGHT: 101.4 lbs (46 kg)

Below measurements are provided in inches, feet, and millimeters (mm).

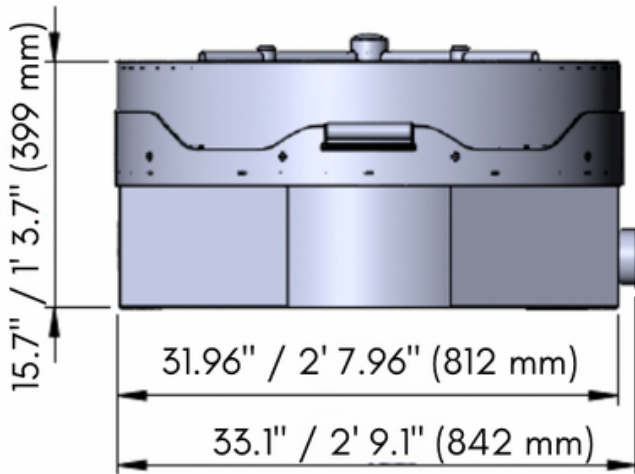

FRONT VIEW

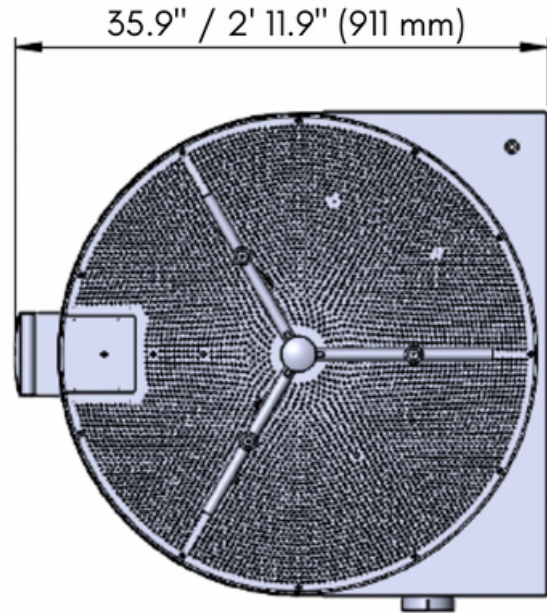

TOP VIEW

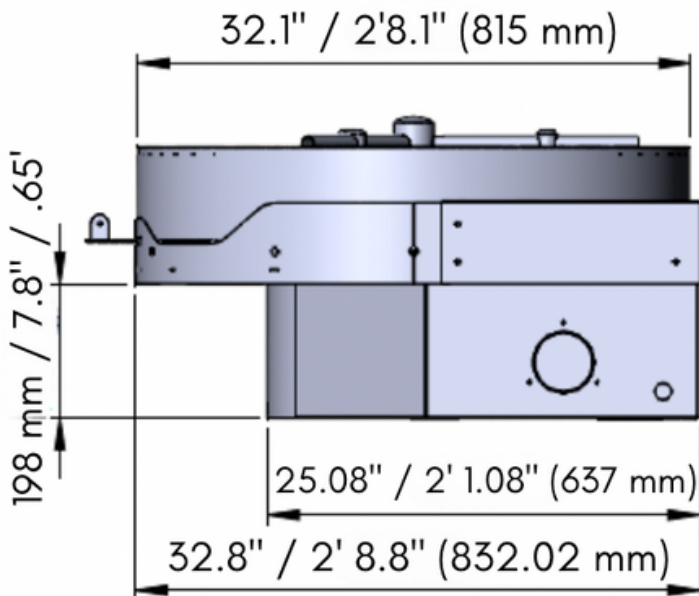

SIDE VIEW

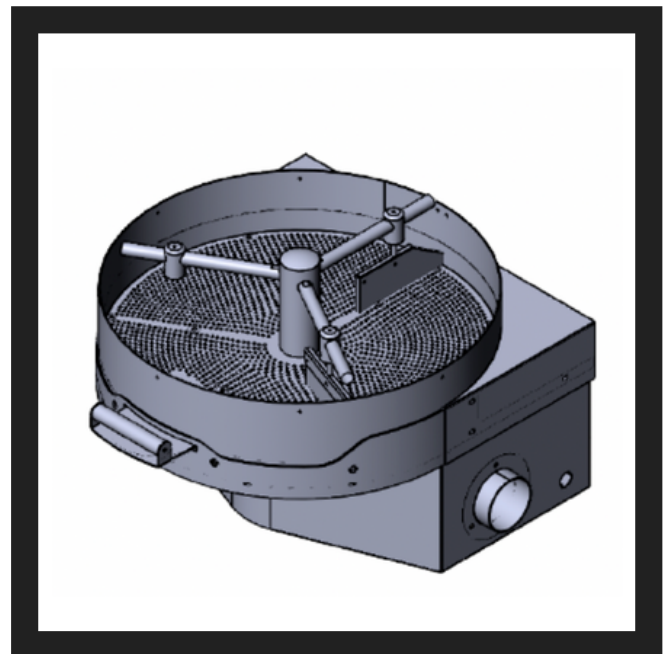

AIR-MOTION 12: CYCLONE

WEIGHT: 275.6 lbs (125 kg)

Below measurements are provided in inches, feet, and millimeters (mm).

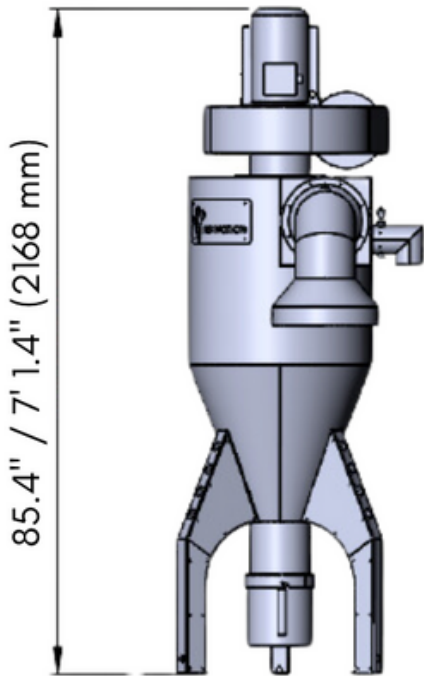

85.4" / 7' 1.4" (2168 mm)

FRONT VIEW

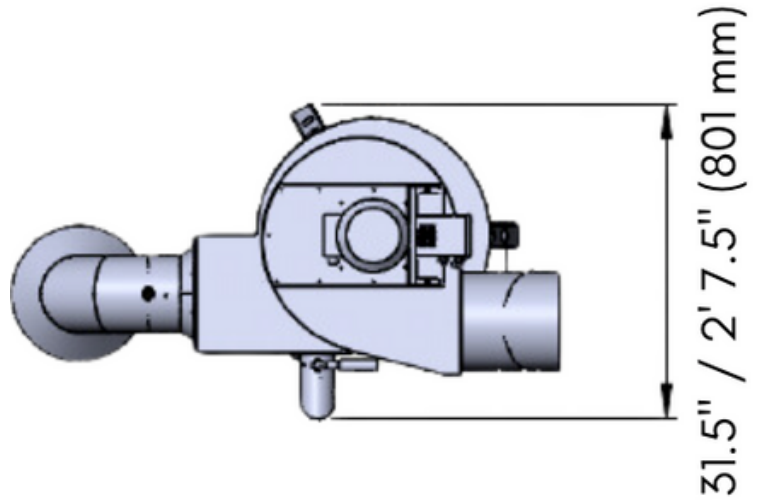

31.5" / 2' 7.5" (801 mm)

TOP VIEW

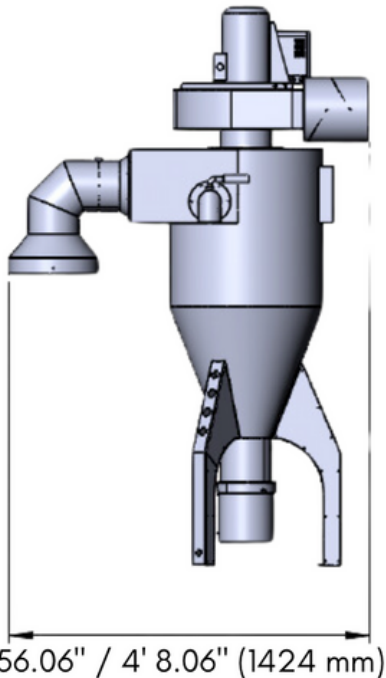

56.06" / 4' 8.06" (1424 mm)

SIDE VIEW

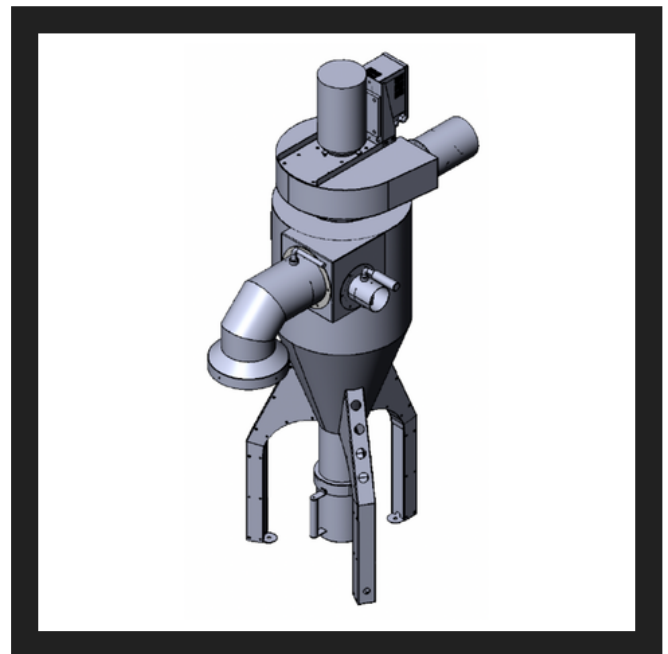

Cyclone Motor
And Fan

Cyclone System
Removes Dust, Smoke &
Chaff from Roast Chamber

**Touchscreen
Interface**
Real-Time
Information & Graphs

Water Dousing System
Immediately Stops Roast Once
Target Temp is Reached

Control Panel
With Operation
Control Dials

Work Light

Element Bank
Immediate Heat
Response Electrical
Element Bank

Roast Chamber
OCR with Clear View

Cooling Tray Ducting
Assists with Rapid Cooling
of Beans in Cooling Tray

Blower Fans
Provides Clean Fresh
Heated Air Into The
Roast Chamber

**Roast Chamber
Exit Chute**

Cooling Tray
Assists with the Rapid
Cooling of Beans

